

Conduit bodies and fittings

For use with Schedule 40 and 80 conduit

Feature unthreaded hubs and textured lids with foam-in-place gaskets.

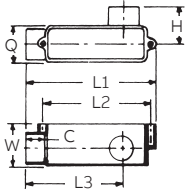

Conduit bodies - Type LR

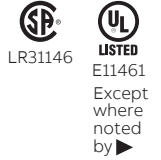

Cat. No.	Size (in.)	Std. Ctn.	Typical max.		Typical		Max. H	Max. Q	Max. W	Vol. Cu. (in.)
			C	L1	L2	L3				
E985D-CAR	1/2	10	11/16	4 ⁵ / ₁₆	3 ⁷ / ₃₂	3 ¹ / ₁₆	1 ⁵ / ₁₆	1 ¹¹ / ₃₂	1 ¹ / ₂	4.0
E985E-CAR	3/4	10	2 ⁹ / ₃₂	6 ⁹ / ₃₂	5 ⁹ / ₃₂	4 ²⁵ / ₃₂	1 ²⁵ / ₃₂	1 ³ / ₄	2 ¹ / ₃₂	12.0
E985F	1	10	2 ⁹ / ₃₂	6 ⁹ / ₃₂	5 ⁹ / ₃₂	4 ²⁵ / ₃₂	1 ²⁵ / ₃₂	1 ³ / ₄	2 ¹ / ₃₂	12.0
E985G	1 ¹ / ₄	10	1 ³ / ₃₂	7 ³¹ / ₃₂	6 ¹³ / ₃₂	6	2 ⁵ / ₁₆	2 ¹ / ₂	2 ³ / ₄	32.0
E985H-CAR	1 ¹ / ₂	5	1 ³ / ₃₂	7 ³¹ / ₃₂	6 ¹³ / ₃₂	6	2 ⁵ / ₁₆	2 ¹ / ₂	2 ³ / ₄	32.0
E985J	2	10	1 ⁵ / ₃₂	9 ³¹ / ₃₂	8 ¹³ / ₃₂	7 ¹ / ₄	2 ⁹ / ₁₆	3 ⁵ / ₃₂	3 ¹⁵ / ₃₂	63.0

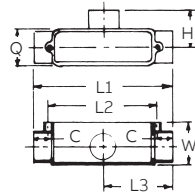

Conduit bodies - Type T

Cat. No.	Size (in.)	Std. Ctn.	Typical max.		Typical		Max. H	Max. Q	Max. W	Vol. Cu. (in.)
			C	L1	L2	L3				
E983D-CAR	1/2	10	11/16	4 ¹¹ / ₁₆	3 ⁷ / ₃₂	2 ¹¹ / ₃₂	1 ⁵ / ₁₆	1 ¹¹ / ₃₂	1 ¹ / ₂	4.0
E983E	3/4	15	2 ⁹ / ₃₂	6 ⁷ / ₈	5 ⁹ / ₃₂	4 ⁷ / ₁₆	1 ²⁵ / ₃₂	1 ³ / ₄	2 ¹ / ₃₂	12.0
E983F	1	20	2 ⁹ / ₃₂	6 ⁷ / ₈	5 ⁹ / ₃₂	3 ⁷ / ₁₆	1 ²⁵ / ₃₂	1 ³ / ₄	2 ¹ / ₃₂	12.0
E983G	1 ¹ / ₄	10	1 ³ / ₃₂	8 ²¹ / ₃₂	6 ¹³ / ₃₂	4 ²¹ / ₆₄	2 ⁵ / ₁₆	2 ¹ / ₂	2 ³ / ₄	32.0
E983H	1 ¹ / ₂	10	1 ³ / ₃₂	8 ²¹ / ₃₂	6 ¹³ / ₃₂	4 ²¹ / ₆₄	2 ⁵ / ₁₆	2 ¹ / ₂	2 ³ / ₄	32.0
E983J	2	10	1 ⁵ / ₃₂	10 ⁵ / ₁₆	8 ¹³ / ₃₂	5 ⁵ / ₃₂	2 ⁹ / ₁₆	3 ⁵ / ₃₂	3 ¹⁵ / ₁₆	63.0

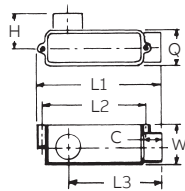

Conduit bodies - Type LL

Cat. No.	Size (in.)	Std. Ctn.	Typical max.		Typical		Max. H	Max. Q	Max. W	Vol. Cu. (in.)
			C	L1	L2	L3				
E984D-CAR	1/2	10	11/16	4 ⁵ / ₁₆	3 ⁷ / ₃₂	2 ¹ / ₁₆	1 ⁵ / ₁₆	1 ¹¹ / ₃₂	1 ¹ / ₂	4.0
E984E	3/4	20	2 ⁹ / ₃₂	6 ⁹ / ₃₂	5 ⁹ / ₃₂	4 ²⁵ / ₃₂	1 ²⁵ / ₃₂	1 ³ / ₄	2 ¹ / ₃₂	12.0
E984F-CAR	1	10	2 ⁹ / ₃₂	6 ⁹ / ₃₂	5 ⁹ / ₃₂	4 ²⁵ / ₃₂	1 ²⁵ / ₃₂	1 ³ / ₄	2 ¹ / ₃₂	12.0
E984G-CAR	1 ¹ / ₄	5	1 ³ / ₃₂	7 ³¹ / ₃₂	6 ¹³ / ₃₂	6	2 ⁵ / ₁₆	2 ¹ / ₂	2 ³ / ₄	32.0
E984H	1 ¹ / ₂	10	1 ³ / ₃₂	7 ³¹ / ₃₂	6 ¹³ / ₃₂	6	2 ⁵ / ₁₆	2 ¹ / ₂	2 ³ / ₄	32.0
E984J	2	10	1 ⁵ / ₃₂	9 ⁹ / ₃₂	8 ¹³ / ₃₂	7 ¹ / ₄	2 ⁹ / ₁₆	3 ⁵ / ₃₂	3 ¹⁵ / ₁₆	63.0